

ASSEMBLY

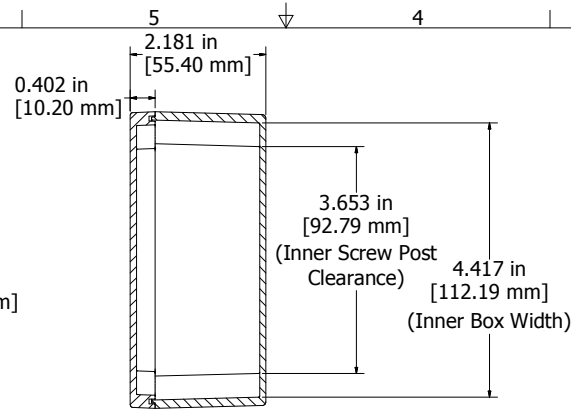

SECTION R-R  
End View of Assembly

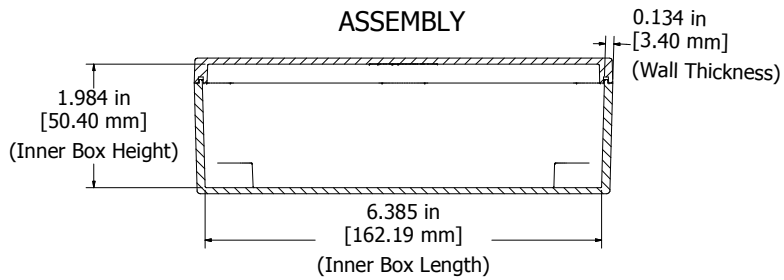
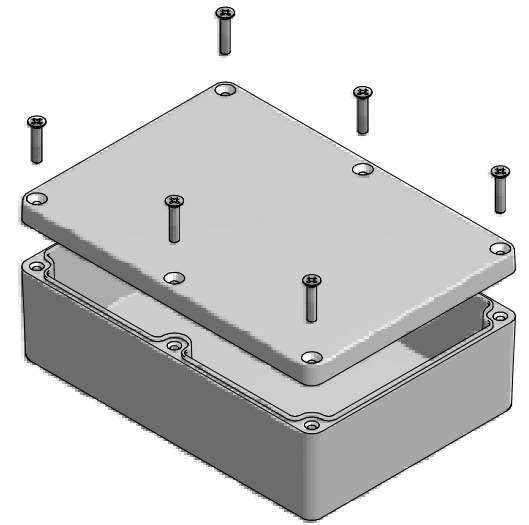

SECTION N-N  
Side View of Assembly

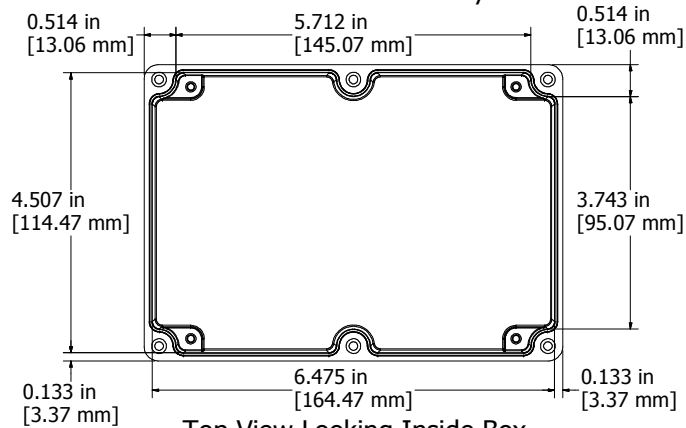

Top View Looking Inside Box

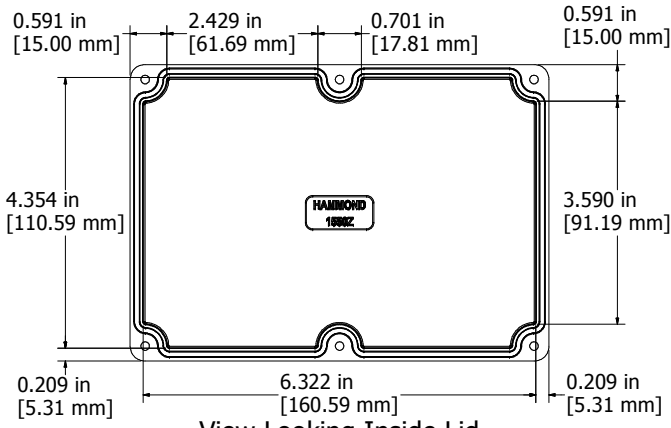

View Looking Inside Lid

Enclosures can be Factory Modified ( Milling, Drilling, Printing etc. )  
Contact Factory [mjm@hammondmg.com](mailto:mjm@hammondmg.com) for quotes  
Solid models of this enclosure available in STEP or IGES.

**NOTES**

- Purchased assembly includes enclosure, M4x20 lid screws
- Gasket - Pre-formed Silicone Rubber
- Cover screws should be torqued to 5-7.5 lbf.in (50-75 cN.m)

**1550Z120**

**PART NUMBERS**

Unfinished	1550Z120
Black Textured Powder Paint - RAL 9011	1550Z120BK



**1550Z120**

[www.hammondmg.com](http://www.hammondmg.com)