

DATE	SYM.	DESCRIPTION	DR	CK	REL

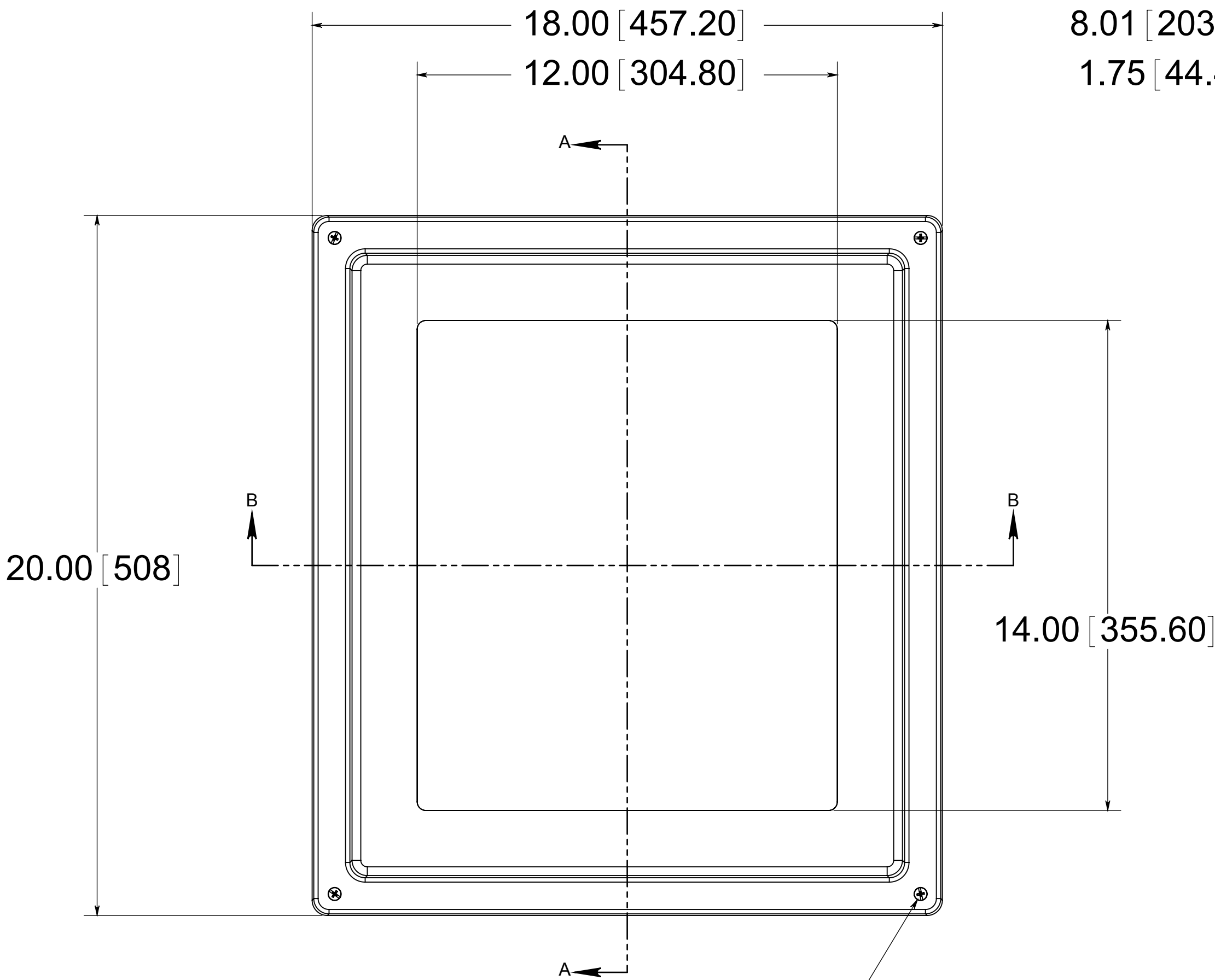

(4) EACH #10-32 BRASS INSERTS  
AND STAINLESS STEEL  
CAPTIVE COVER SCREWS  
WITH RETAINING O-RING

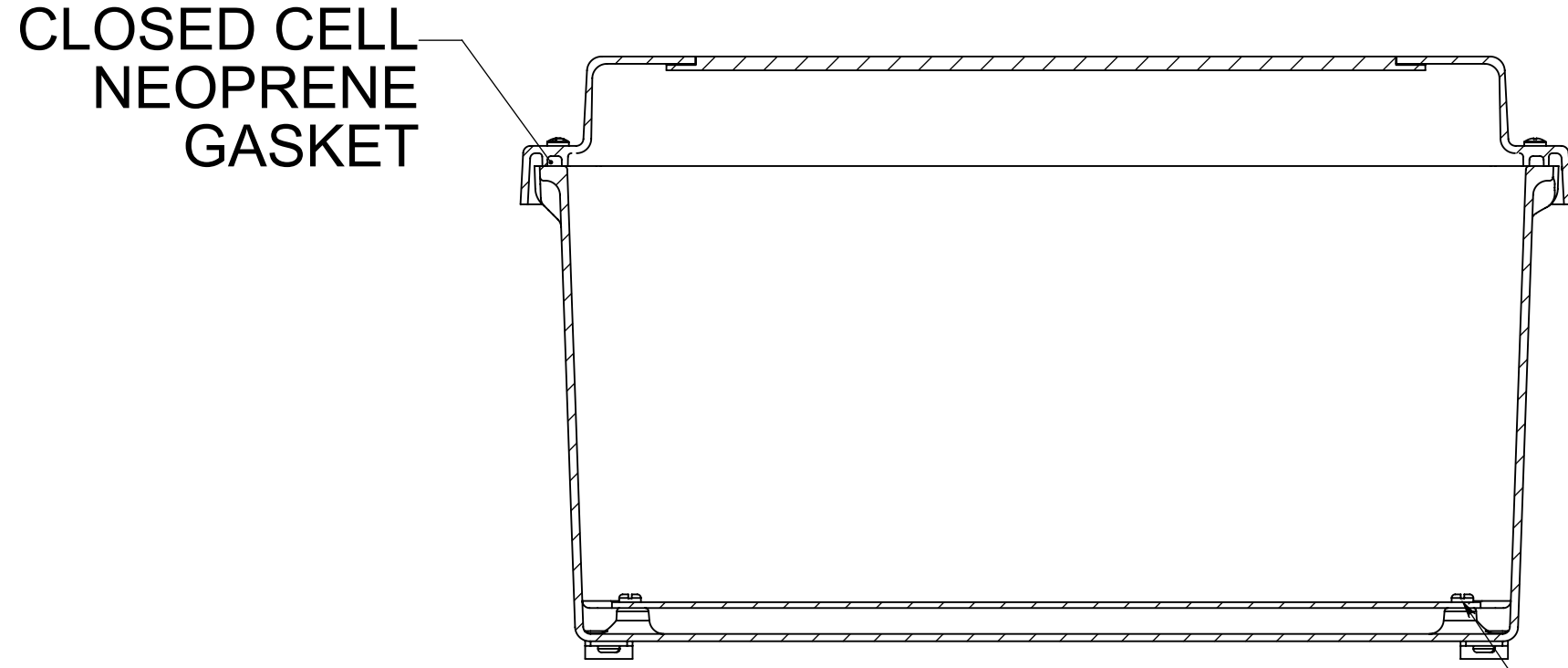

SECTION B-B

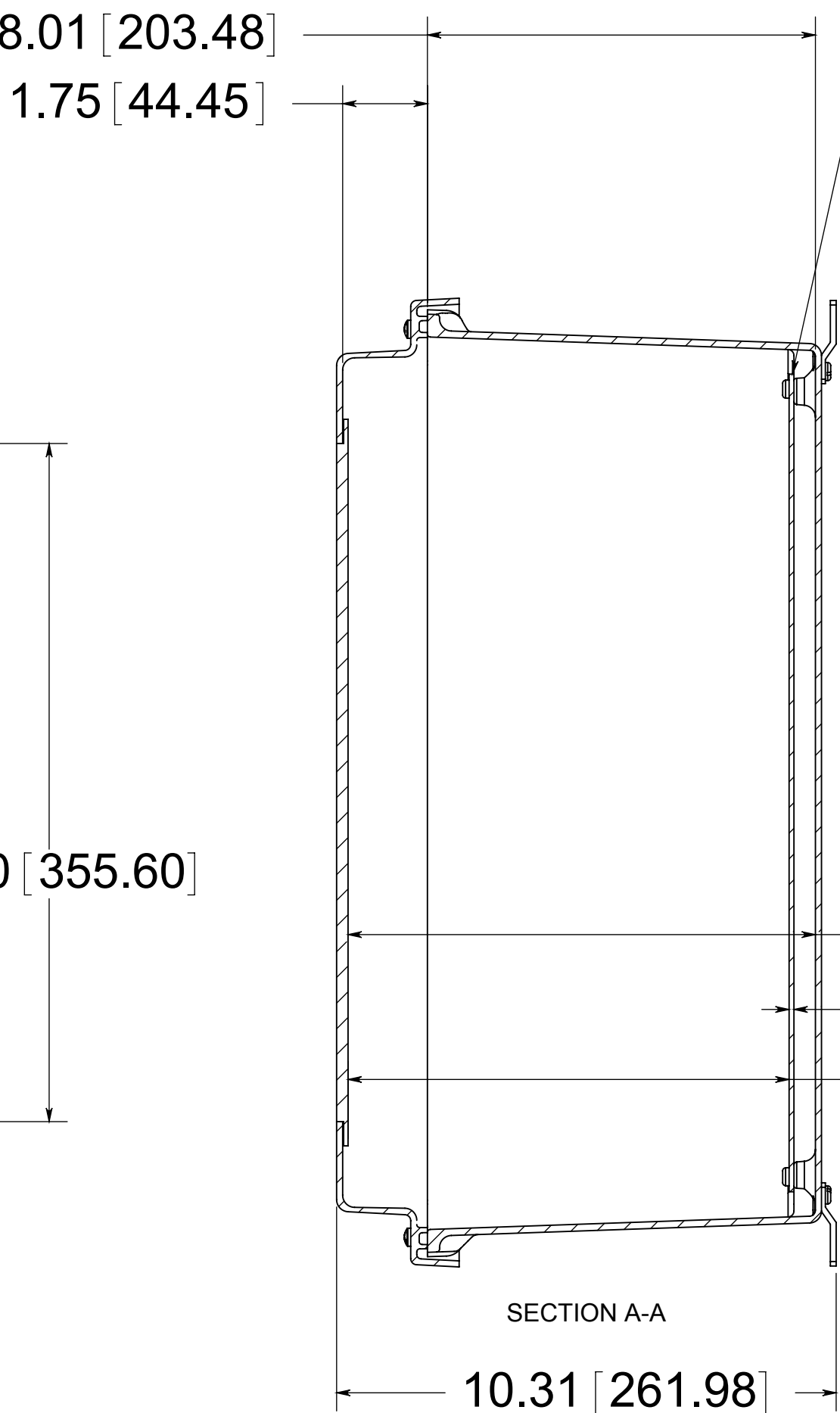

SECTION A-A

OPTIONAL BACK PANEL  
0.100 [2.54] TH'K- ALUMINUM  
0.075 [1.91] TH'K- WHITE STEEL & GALVANNEALED  
0.125 [3.18] TH'K- FIBERGLASS

(4) STAINLESS STEEL  
MOUNTING FEET

(4) EACH #10-32 BRASS  
INSERTS, AND STAINLESS  
STEEL FEET SCREWS

(4) Ø.34 [8.74]

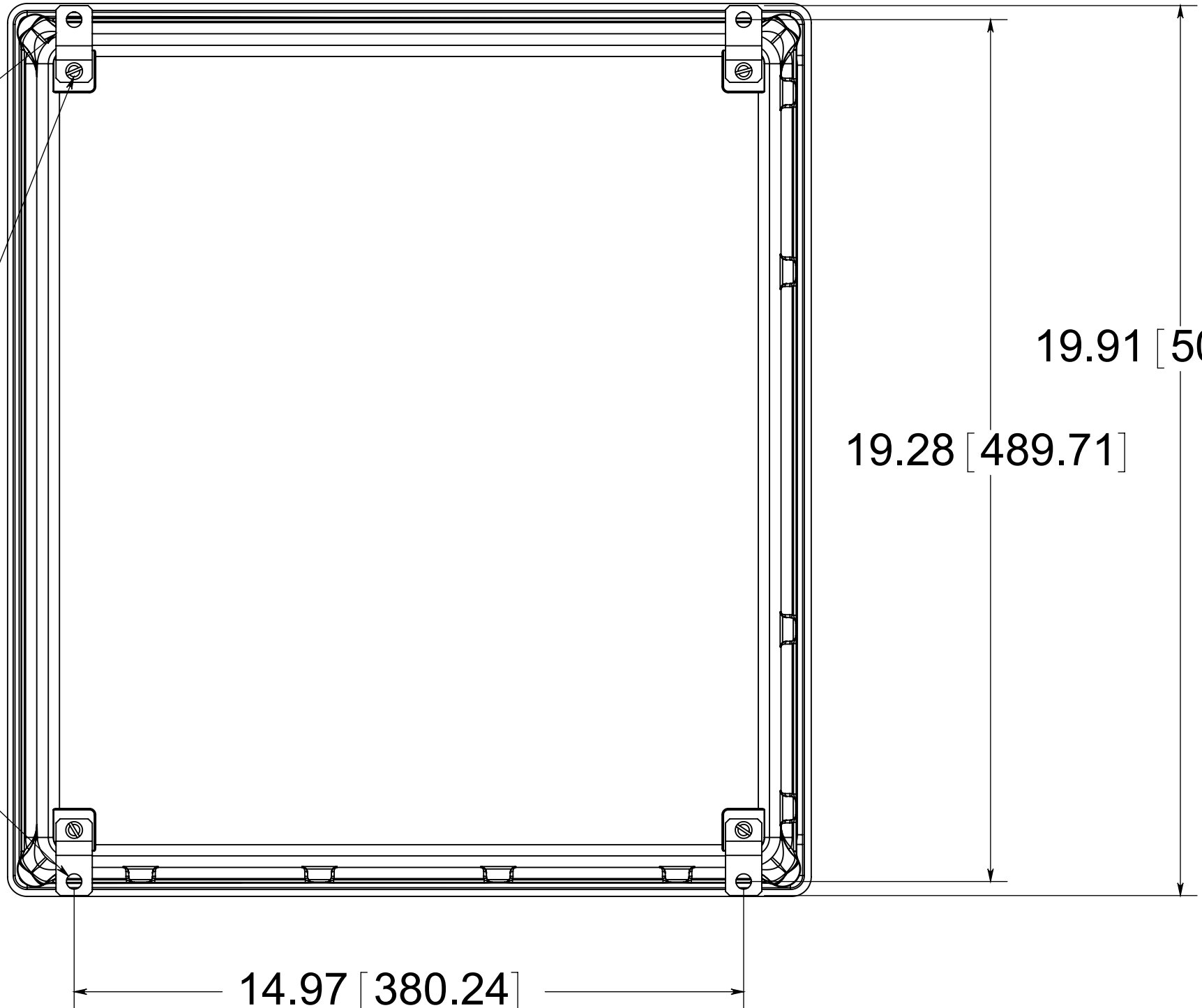

FRONT VIEW  
WITH COVER REMOVED  
AND BACK PANEL SHOWN

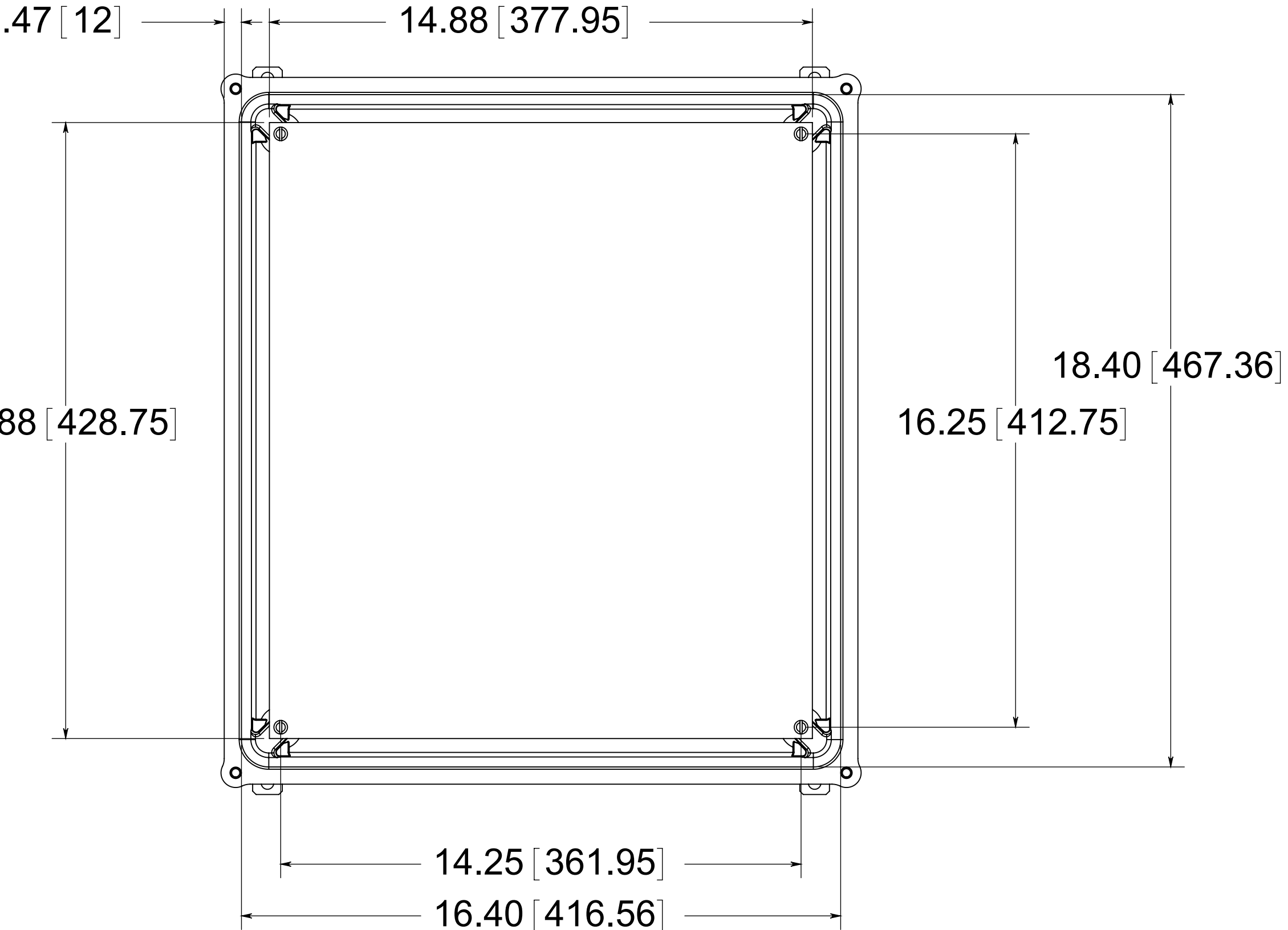

(4) EACH #10-32 BRASS  
INSERTS AND PLATED  
CARBON STEEL SCREWS

MATERIAL:  
BOX- COMPRESSION MOLDED FIBERGLASS REINFORCED POLYESTER  
COVER- COMPRESSION MOLDED FIBERGLASS REINFORCED POLYESTER  
WINDOWS- POLYCARBONATE

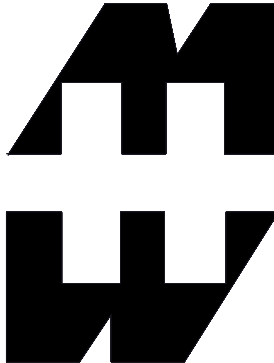

PART No. PJ1868RW  
for more information visit  
[www.hammfg.com](http://www.hammfg.com)  
Data subject to change without notice  
Drawing Not to Scale